

Cam switches

Complete products 10 A

Catalog
April
2004



Cam switches

Complete products 10 A

The range of K10 cam switches (10 A rating) comprises only complete switches. These products are more specifically designed for process control applications:

- compact size,
- easy to integrate with other Ø 16 and Ø 22 mm units,
- selection functions.

Complete products

- OFF-ON switches
- stepping selector switches
- changeover switches

Front mounting switches

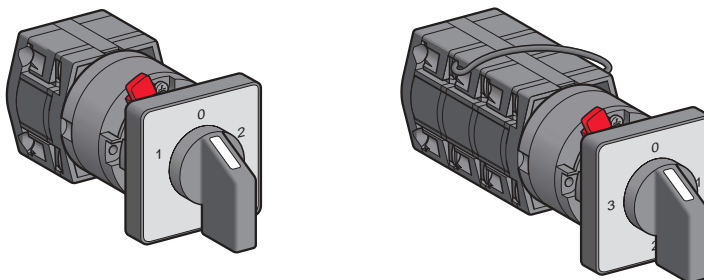

Single Ø 16.3 or Ø 22.3 mm hole fixing

Mounting method

Single Ø 16 or Ø 22 hole fixing

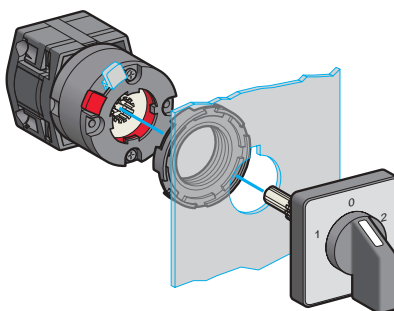

Locking/unlocking of the body-head assembly by means of a lug

Single Ø 16 hole fixing

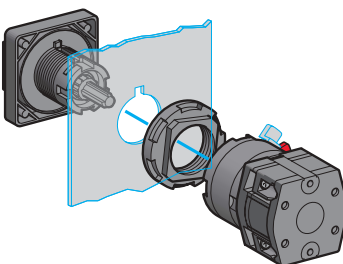

Single Ø 22 hole fixing

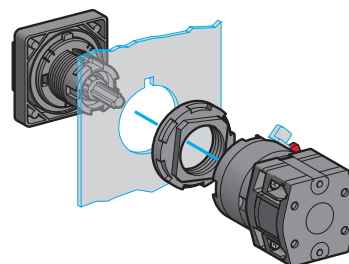

Cam switches

Complete products, 10 A

Front mounting, single Ø 16 or Ø 22 mm hole fixing

With 30 x 30 mm front plate

Environment

Conforming to standards	IEC/EN 60947-3 IEC/EN 60947-5-1
Approvals	cULus
Protective treatment	Standard version: "TC"
Ambient air temperature	Operation: - 20...+ 55 °C Storage: - 40...+ 70 °C
Electric shock protection	Class II, conforming to IEC 60536
Degree of protection	IP 65 conforming to IEC 60529 (operating head) IP 20 (contact block)
Mechanical durability	1 million operating cycles

Contact block characteristics

Rated operational characteristics	AC-15, A300	–	240 V	3 A
			120 V	6 A
	AC-21A, AC-1	–	400 V	10 A
	UL/Canada Heavy Duty A300	3-phase	110/120 V	0.75 HP
			220/240 V	1 HP
		Single-phase	110/120 V	0.33 HP
			220/240 V	0.75 HP
	AC-23A	3-phase	220/240 V	1.8 kW
			110/120 V	0.37 kW
		Single-phase	220/240 V	0.75 kW
d.c. current le resistive load	1 contact	24 V	10 A	
		110 V	0.7 A	
		220 V	0.3 A	
Short-circuit protection	Cartridge fuse 10 A gG			
Conventional thermal current (I _{th})	10 A			
Rated insulation voltage (U _i)	440 V, degree of pollution 3 conforming to IEC 60947-1			
Contact operation	Slow break			
Terminal referencing	Conforming to CENELEC EN 50013			
Rated impulse withstand voltage (U _{imp})	4 kV conforming to IEC 60947-1			
Electrical reliability	Failure rate < 1 failure, for 100 million operating cycles (--- 24 V PLC inputs)			
Cabling	Screw and captive cable clamp terminals Clamping capacity: 2 x 1.5 mm ²			

Cam switches

Complete products, 10 A

Front mounting, single Ø 16 or Ø 22 mm hole fixing

With 30 x 30 mm front plate



K10-B002ACH

OFF-ON switches

Wiring scheme and switching scheme	Marking & switch position	Number of poles	Reference	Weight kg
		1	K10-A001ACH	0.030
		2	K10-B002ACH	0.035
		3	K10-C003ACH	0.045
		4	K10-D004ACH	0.045

Stepping switches, single-pole, with "O" position

Wiring scheme and switching scheme	Marking & switch position	Number of poles	Reference	Weight kg
		2 + "0"	K10-B002QCH	0.035
		3 + "0"	K10-C003QCH	0.045
		4 + "0"	K10-D004QCH	0.045



K10-D004QCH

Cam switches

Complete products, 10 A

Front mounting, single Ø 16 or Ø 22 mm hole fixing

With 30 x 30 mm front plate



K10-D012QCH

Stepping switches, 2-pole, with "O" position

Wiring scheme and switching scheme	Marking & switch position	Number of poles	Reference	Weight kg
		2 + "0"	K10-D012QCH	0.045

		3 + "0"	K10-F013QCH	0.055
--	--	---------	--------------------	-------

Stepping switches, single-pole, without "O" position

		3	K10-C003NCH	0.045
--	--	---	--------------------	-------

		4	K10-D004NCH	0.045
--	--	---	--------------------	-------

Cam switches

Complete products, 10 A

Front mounting, single Ø 16 or Ø 22 mm hole fixing

With 30 x 30 mm front plate

Stepping switches, 2-pole, without "O" position

Wiring scheme and switching scheme	Marking & switch position	Number of poles	Reference	Weight kg
		3	K10-F013NCH	0.055

Changeover switch with spring return

Wiring scheme and switching scheme	Marking & switch position	Number of poles	Reference	Weight kg
		1	K10-B006TCH	0.035



K10-B006TCH

Changeover switches with "O" position

Wiring scheme and switching scheme	Marking & switch position	Number of poles	Reference	Weight kg
		1	K10-B001UCH	0.035
		2	K10-D002UCH	0.045
		3	K10-F003UCH	0.055
		4	K10-H004UCH	0.065



K10-F003UCH

Changeover switches without "O" position

Wiring scheme and switching scheme	Marking & switch position	Number of poles	Reference	Weight kg
		1	K10-B011UCH	0.035
		2	K10-D012UCH	0.045
		3	K10-F013UCH	0.055
		4	K10-H014UCH	0.065

Cam switches

Complete products, 10 A

Front mounting, single Ø 16 or Ø 22 mm hole fixing

With 30 x 30 mm front plate



K10-F027MCH

Voltmeter switches

For measurement between phases and between phase and neutral

Wiring scheme and switching scheme	Marking & switch position	Reference	Weight kg
		K10-F027MCH	0.055

For measurement between phases, with "O" position

		K10-D024MCH	0.045

Ammeter switches

3 measurement points, with neutral position



K10-F003MCH

		K10-F003MCH	0.055

Cam switches

Complete products, 10 A

Front mounting, single Ø 16 or Ø 22 mm hole fixing

With 30 x 30 mm front plate

Accessories

540016

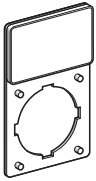

Z227N

501646_1

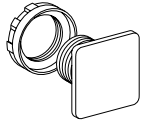

Z33

501647_1

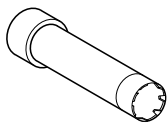

Z201

Legend holders

Description		Sold in lots of	Unit reference	Weight kg
For Ø 22 mm hole fixing	With metallic finish legend	25	Z227N	0.060

Accessories

Description	Colour	Sold in lots of	Unit reference	Weight kg
Blanking plug	Black	10	Z33	0.060
Nut wrench	-	5	Z201	0.020

Cam switches

Complete products, 10 A

Front mounting, single Ø 16 or Ø 22 mm hole fixing

With 30 x 30 mm front plate

Cam switches 10 A

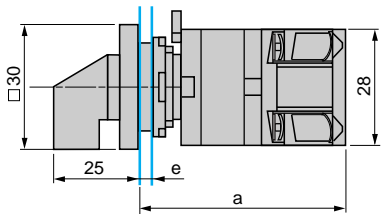

	a
K10-A, B	51
K10-C, D	63
K10-F	75
K10-H	87

e : thickness of support 0.5 to 5.5 mm.

Single Ø 16 or Ø 22 mm hole fixing

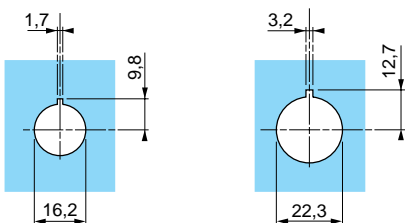

Contact functions: how to understand the conventions used

Link positions (factory mounted)

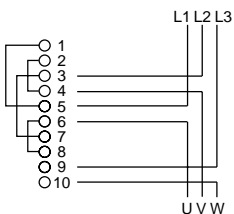

Graphic representation of switching positions and spring return to "O" position

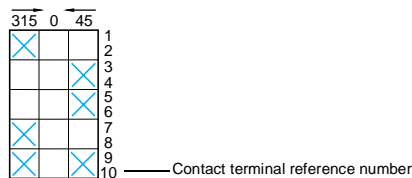

Contact closed



Contact closed in 2 positions and maintained between the 2 positions



Sealed assembly for auto-maintain control



Overlapping contacts

Angular position of switch

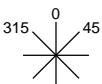

Schneider Electric Industries SAS

Headquarters

89, bd Franklin Roosevelt
F - 92506 Rueil Malmaison Cedex

<http://www.schneider-electric.com>

Owing to changes in standards and equipment, the characteristics given in the text and images in this document are not binding until they have been confirmed with us.

Production : Schneider Electric Industries
Photos : Schneider Electric Industries
Printed by : CCI



9003CT0401

April 2004