

General Purpose Fittings Series

Fittings

One-touch connection and release
Possible to use in vacuum to -100 kPa

Miniature One-touch Fittings
Series KJ

Applicable tubing—Metric size



Applicable tubing material	Applicable tubing O.D. (mm)								With seal	Electroless nickel plated	Page
	ø2	ø3.2	ø4	ø6	ø8	ø10	ø12	ø16			
FEP	M3	●	●	●						●	18
PFA	M5	●	●	●	●					●	
Nylon	1/8		●	●	●				●	●	
Soft nylon	1/8		●	●	●				●	●	
Polyurethane	Unions	●	●	●	●					●	

Inch-size tube/UNF, NPT thread connection

Miniature One-touch Fittings
Series KJ

Applicable area—U.S.A., etc.



Applicable tubing material	Applicable tubing O.D. (inch)								With seal	Electroless nickel plated	Page
	10-32 UNF	1/16	1/8	3/16	1/4	5/16	3/8	1/2			
FEP	10-32 UNF	●	●	●						●	28
PFA	1/16	●	●	●	●					●	
Nylon	1/8	●	●	●	●	●			●	●	
Soft nylon	1/8	●	●	●	●	●			●	●	
Polyurethane	Unions	●	●	●	●					●	

One-touch connection and release
Possible to use in vacuum to -100 kPa

One-touch Fittings
Series KQ2

Applicable tubing—Metric size



Applicable tubing material	Applicable tubing O.D. (mm)								With seal	Electroless nickel plated	Page
	ø2	ø3.2	ø4	ø6	ø8	ø10	ø12	ø16			
FEP	M5	●	●	●						●	38
PFA	M6	●	●	●	●					●	
Nylon	1/8	●	●	●	●	●			●	●	
Soft nylon	3/8			●	●	●	●	●	●	●	
Polyurethane	Unions	●	●	●	●	●	●	●	●	●	

Inch-size tube/UNF, NPT thread connection

One-touch Fittings
Series KQ2

Applicable area—U.S.A., etc.



Applicable tubing material	Applicable tubing O.D. (inch)								With seal	Electroless nickel plated	Page
	10-32 UNF	1/16	1/8	3/16	1/4	5/16	3/8	1/2			
FEP	10-32 UNF	●	●	●	●					●	60
PFA	1/16	●	●	●	●	●				●	
Nylon	1/8	●	●	●	●	●	●		●	●	
Soft nylon	3/8			●	●	●	●	●	●	●	
Polyurethane	Unions	●	●	●	●	●	●	●	●	●	

Inch-size tube/M5, R, Rc thread connection

One-touch Fittings
Series KQ2

Applicable area—Australia, Japan, etc.



Applicable tubing material	Applicable tubing O.D. (mm)								With seal	Electroless nickel plated	Page
	ø2	ø3.2	ø4	ø6	ø8	ø10	ø12	ø16			
FEP	M5	●	●	●						●	76
PFA	1/8	●	●	●	●					●	
Nylon	1/4	●	●	●	●	●			●	●	
Soft nylon	3/8			●	●	●	●	●	●	●	
Polyurethane	Unions	●	●	●	●	●	●	●	●	●	

Fittings

New-stand male thread for piping that reduces the screw-in time by 1/3.

Uni One-touch Fittings Series KQ2

Applicable tubing—Metric size



Applicable tubing material	Applicable tubing O.D. (mm)							With seal	Electroless nickel plated	Page
	ø2	ø3.2	ø4	ø6	ø8	ø10	ø12			
FEP			•	•	•	•				84
PFA			•	•	•	•				
Nylon										
Soft nylon					•	•	•	•		
Polyurethane							•	•	•	

New-stand male thread for piping that reduces the screw-in time by 1/3.

Uni One-touch Fittings Series KQ2

Applicable tubing—Inch size



Applicable tubing material	Applicable tubing O.D. (inch)							With seal	Electroless nickel plated	Page
	ø1/8"	ø3/32"	ø3/16"	ø1/4"	ø5/16"	ø3/8"	ø1/2"			
FEP	•	•	•	•	•					92
PFA	•	•	•	•	•					
Nylon										
Soft nylon					•	•	•	•		
Polyurethane							•	•		

Body: Brass (C3604, C3771)
Release button: Stainless steel 304

Brass One-touch Fittings Series KQB

Applicable tubing—Metric size

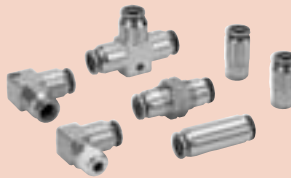

Applicable tubing material	Applicable tubing O.D. (mm)							With seal	Electroless nickel plated	Page
	ø2	ø3.2	ø4	ø6	ø8	ø10	ø12			
FEP			•	•						99
PFA			•	•	•				•	
Nylon					•	•	•		•	
Soft nylon						•	•	•	•	
Polyurethane							•	•	•	
Unions			•	•	•	•	•		•	
Polyolefin										

Low-torque rotation style

Rotary One-touch Fittings Series KS (Standard) Series KX (High speed)

Applicable tubing—Metric size



Applicable tubing material	Applicable tubing O.D. (mm)							With seal	Electroless nickel plated	Page
	ø2	ø3.2	ø4	ø6	ø8	ø10	ø12			
FEP			•	•						106
PFA			•	•					•	
Nylon			•	•	•				•	
Soft nylon					•	•	•		•	
Polyurethane						•	•		•	
Unions			•	•	•	•	•		•	

Low-torque rotation style

Rotary One-touch Fittings Series KS (Standard)

Applicable tubing—Inch size UNF, NPT thread connection



Applicable tubing material	Applicable tubing O.D. (inch)							With seal	Electroless nickel plated	Page
	ø1/8"	ø3/32"	ø3/16"	ø1/4"	ø5/16"	ø3/8"	ø1/2"			
FEP										110
PFA			•						•	
Nylon			•	•	•				•	
Soft nylon					•	•	•		•	
Polyurethane						•	•		•	

One-touch connection and release
Compact manifold piping possible

One-touch Fittings Manifold Series KM

Applicable tubing—Metric size



Applicable tubing material	Applicable tubing O.D. (mm)							With seal	Electroless nickel plated	Page
	ø2	ø3.2	ø4	ø6	ø8	ø10	ø12			
FEP			•	•						114
PFA			•	•					•	
Nylon					•				•	
Soft nylon					•				•	
Polyurethane						•			•	

General Purpose Fittings Series

Fittings

One-touch connection and release
Compact manifold piping possible

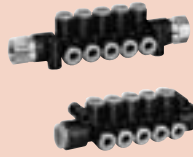

One-touch Fittings Manifold
Series KM

Applicable tubing—Inch size NPT thread connection

Possible to use in vacuum to 1.0 MPa

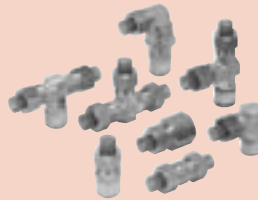

Insert Fittings
Series KF

Applicable tubing—Metric size

Compact and non-tool connection

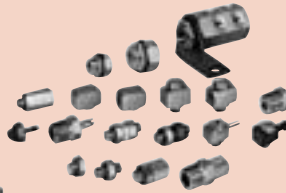

Miniature Fittings
Series M

Applicable tubing—Metric size

Applicable for use on soft copper steel pipe



Self-align Fittings
Series H/DL/L/LL

Applicable tubing—Metric size

One-touch connection and release
Built-in self-seal mechanism



Self-seal Fittings
Series KC

Applicable tubing—Metric size

Compact with large flow rate

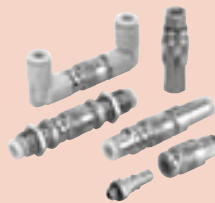

S Couplers
Series KK

Super high impact PBT



S Couplers
Series KKH

Manufactured by RECTUS AG



S Couplers
Series KK13

Applicable tubing material	Applicable tubing O.D. (inch)								With seal	Electroless nickel plated	Page
	1/8"	3/16"	1/4"	5/16"	3/8"	1/2"	3/4"	1"			
FEP											120
PFA											
Nylon											
Soft nylon											
Polyurethane											

Applicable tubing material	Applicable tubing O.D. (mm)								With seal	Electroless nickel plated	Page
	2	3.2	4	6	8	10	12	16			
Nylon											123
Soft nylon											
Polyurethane											
Polyolefin											
Soft polyolefin											

Applicable tubing material	Thread	Applicable tubing O.D. (mm)								With seal	Electroless nickel plated	Page
		2	3.2	4	6	8	10	12	16			
FEP	M3											139
Modified PTFE	M3											
Nylon	M5											
Soft nylon	M5											

Applicable tubing material	Thread	Applicable tubing O.D. (mm)								With seal	Electroless nickel plated	Page
		2	3.2	4	6	8	10	12	16			
Nylon	1/8"											150
Soft nylon	1/8"											
Soft nylon	1/4"											
Soft nylon	3/8"											
Soft copper (C1220T-0)	1/2"											

Applicable tubing material	Thread	Applicable tubing O.D. (mm)								With seal	Electroless nickel plated	Page
		2	3.2	4	6	8	10	12	16			
Nylon	M5											156
Soft nylon	M5											
Soft nylon	1/8"											
Soft nylon	1/4"											

Applicable tubing material	Thread	Applicable tubing O.D. (mm)								With seal	Electroless nickel plated	Page
		2	3.2	4	6	8	10	12	16			
Male thread type	R											165
Female thread type	Rc											
Nut fitting type												

Applicable tubing material	Thread	Applicable tubing O.D. (mm)								With seal	Electroless nickel plated	Page
		2	3.2	4	6	8	10	12	16			
One-touch fitting type												174
Male thread type	R											
Female thread type	Rc											

Applicable tubing material	Thread	Applicable tubing O.D. (mm)								With seal	Electroless nickel plated	Page
		2	3.2	4	6	8	10	12	16			
Male thread type	R											177
Female thread type	Rc											
Barb fitting type												
Nut fitting type												
Nut fitting type												

General Purpose Fittings Series

Fittings

One-touch installation and removal of multi-tubes

Multi-connector *Series DM*



Applicable tubing—Metric size

One-touch installation and removal of multi-tubes

Multi-connector with One-touch fittings *Series DMK*



Applicable tubing—Metric size

One-touch installation and removal of multi-tubes

Rectangular Multi-connector *Series KDM*

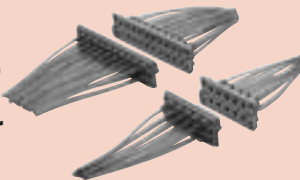

Applicable tubing—Metric size

One-touch installation and removal of multi-tubes

Rectangular Multi-connector *Series KDM*

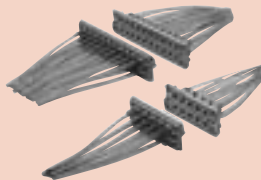

Applicable tubing—Inch size

Centralized distribution of supply air

Piping Module *Series KB*

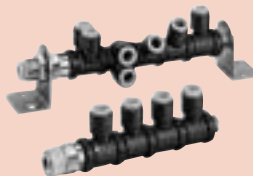

Applicable tubing—Metric size

Applicable tubing material	Applicable tubing O.D. (mm)	With seal	Electroless nickel plated	Page
Nylon	6 tubes			186
Polyurethane	12 tubes			186
Soft nylon	6 tubes			190
Nylon	12 tubes			190
Polyurethane	10 tubes			194
Soft nylon	20 tubes			194
FEP	10 tubes			198
Nylon	20 tubes			198
Polyurethane				198
PFA				203
Soft nylon				203

- K
- M
- H
- KK
- D
- MS
- LQ
- MQR
- T

For Pneumatic Piping/Fittings & Tubing Prior to Use

Fittings with Sealant

Seal material (fluoro resin) is coated on the thread part with the proper thickness and range, that reduces the piping work, such as coating the seal on the thread.

