

# ***P04-37x120F/135-HP-R Linear Motor***

**LinMot®**

## **Direct linear motor technology from LinMot**

- Stator and slider fully encapsulated
- Designed for roughest environment
- Hardened rod capable to handle side load
- Non-rotating rod

## **PS01-37x120F-HP motor based**

- Max velocity 3.9 m/s (154 in/s)
- Peak Force 255 N (57 lbf)
- Stroke 135 mm (5.3 in)
- Single cable for power and sensors

## **Mounting and Accessories**

- According to ISO pneumatic cylinder
- Ø 16 mm rod with M10x1.25 thread
- Additional T-slots



# P04-37x120F/135-HP-R Linear Motor

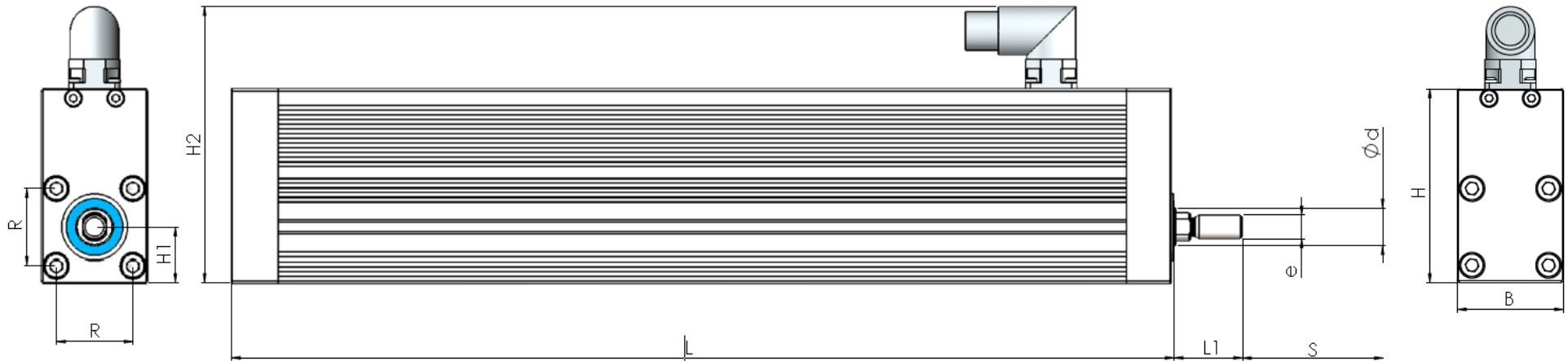

L	B	H	H1	H2	L1	d	e	R	S
400 mm	45 mm	82 mm	23.5 mm	117 mm	29 mm	16 mm	M10x1.25	32.5 mm	0 – 135 mm

Standard brackets and rod end accessories from pneumatic cylinders can be used:

